

SEGMENT	MAIN TUBE PLATE		SUPPORT TUBE PLATE	
	TOTAL HOLES	PERIPHERAL HOLES	TOTAL HOLES	PERIPHERAL HOLES
A	2642	330	2650	338
B	1165	152	1168	155
C	1165	152	1168	155
D	239	48	239	48
E	239	48	239	48
F	855	104	857	106
G	1479	170	1483	172
H	1479	170	1483	172
J	1468	169	1472	171
K	1468	169	1472	171
TOTAL	12199		12231	

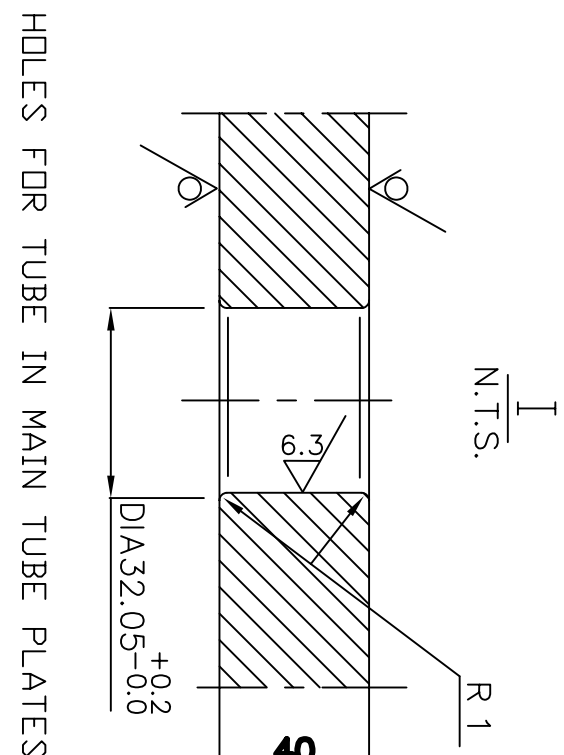

HOLES FOR TUBE IN MAIN TUBE PLATES

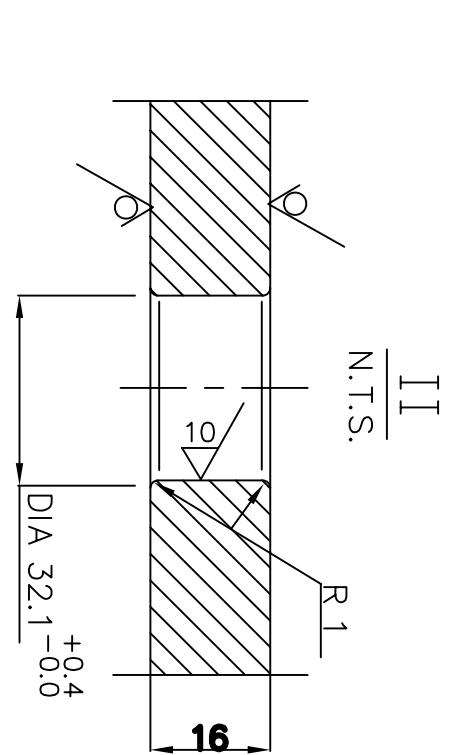

HOLES FOR TUBE IN SUPPORT TUBE PL

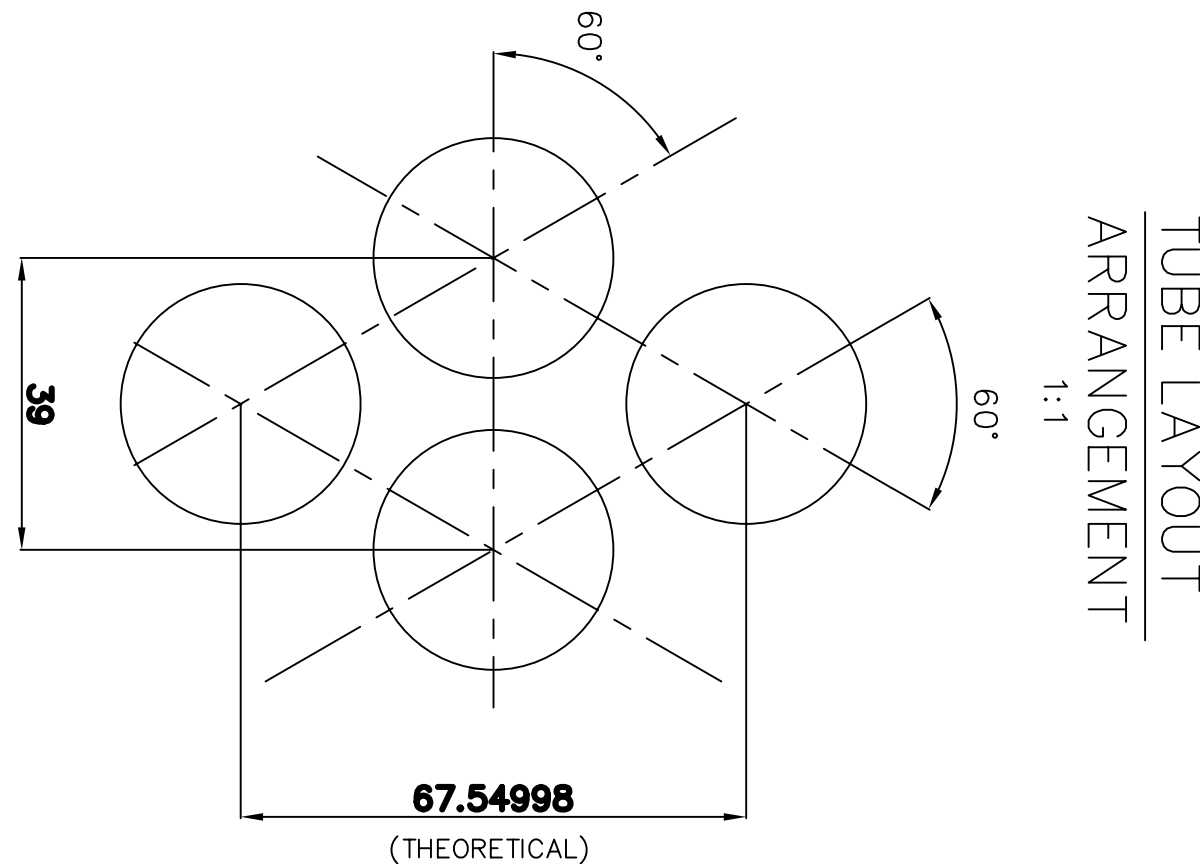

TUBE LAYOUT

1. NO. OF TUBE HOLES IN EACH SUPPORT PLATE = 1223 NOS
2. NO. OF TUBE HOLES IN EACH MAIN TUBE PLATE = 1219 NOS

5. PITCH = 39mm.
6. TOLERANCE ON PITCH ± 1 mm.
7. CUMULATIVE TOLERANCE ON PITCHES ± 2.0 mm
8. MINIMUM LIGAMENT BETWEEN HOLES SHOULD NOT BE LESS THAN 1 mm FROM NOMINAL.
9. NO SPIRAL OR AXIAL GROOVES IN HOLES ARE ALLOWED.
10. UP TO 4% OF HOLES MAY BE ALLOWED WITH MAXIMUM SURFACE FINISH IN TUBE PLATE AND TUBE SUPPORT PLATE RESPECTIVELY.
11. REFER TABLE FOR NO. OF HOLES IN EACH ZONE.
12. RADIOUS OF 1 MM ON BOTH SIDE OF HOLES IS FOR REMOVING BURRS FROM HOLES ONLY.
13. THE LAYOUT SHOWN IS FOR THE RIGHT HAND SIDE. LAYOUT FOR THE OTHER HALF IS THE MIRROR IMAGE OF THIS LAYOUT.
- ①②③④ HOLES MARKED * ARE NOT TO BE DRILLED ON MAIN TUBE PLATE.

REFERENCE DRAWINGS:

- | | |
|-----------------------|-------------|
| 1. MAIN TUBE PLATE | 21601870028 |
| 2. SUPPORT TUBE PLATE | 21602870026 |

[illegible]